



## S4 rechargeable QUICK GUIDE

This manual may contain typographical errors.  
Data and information are subject to  
change without notice



FOR MORE INFO

Steiner A/S  
Dyssevej 3  
DK-8200 Århus N  
Phone: +45 87 52 52 12  
Fax: +45 87 52 52 15  
Contact: [info@suprabeam.com](mailto:info@suprabeam.com)  
[www.suprabeam.com](http://www.suprabeam.com)

### Head angle

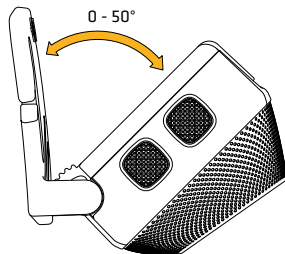

### Changing and charging battery

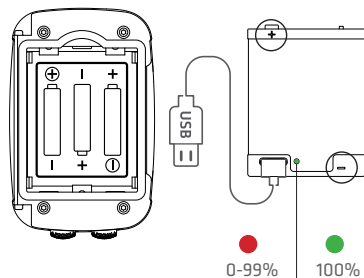

### Helmet mount

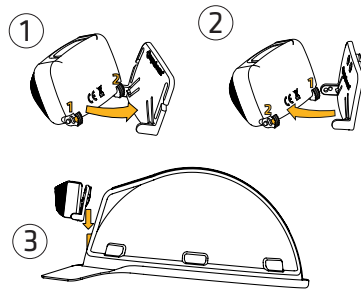

\*Helmet mount is sold separately

### Additional online information

### Warning



#### Eye Safety

Risk Group 2  
(IEC 62471)



### Specifications



Li-Po



85 m

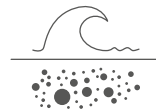

IP 68



136 g

## Light Control Functions

### TOP BUTTON (MOON)

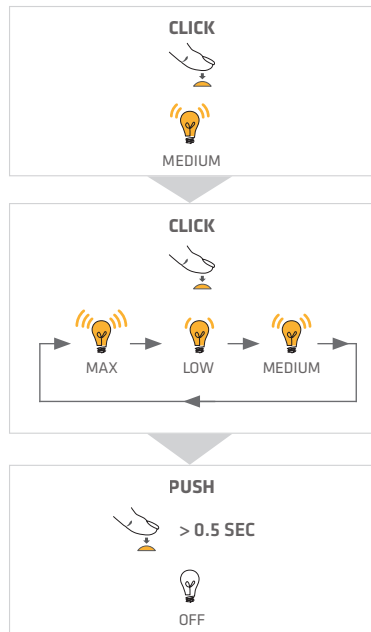

### BOTTOM BUTTON (SPOT)

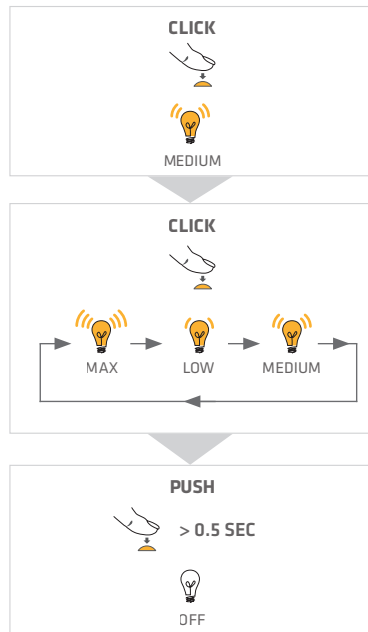

### BOTH BUTTONS

